

## ONE YEAR LIMITED WARRANTY

This SKUTCH PRODUCT is warranted against defects for a period of one (1) year from the date of original invoice. Within this period, we will repair the PRODUCT without charge for parts and labor. To obtain warranty service the product must be returned, at the customer's expense, to SKUTCH Electronics along with a copy of the original invoice. After the unit has been repaired, SKUTCH will ship the PRODUCT back via UPS GROUND service at our expense. If any other form of return shipment is requested, the customer will pay for 100% of the shipping cost.

This Warranty does not apply if in the sole opinion of SKUTCH Electronics, the product has been damaged by lightning or any other Acts of God, or by accident, misuse, neglect, or improper packing, shipping, modification or servicing by other than an authorized SKUTCH Service Center.

EXCEPT AS SPECIFICALLY PROVIDED IN THIS AGREEMENT, THERE ARE NO OTHER WARRANTIES, EXPRESSED OR IMPLIED, INCLUDING, BUT NOT LIMITED TO, ANY IMPLIED WARRANTIES OR MERCHANTABILITY OR FITNESS FOR A PARTICULAR PURPOSE AND IN NO EVENT SHALL SKUTCH ELECTRONICS BE LIABLE FOR LOSS OF PROFITS OR BENEFITS, INDIRECT, SPECIAL, CONSEQUENTIAL OR OTHER SIMILAR DAMAGES ARISING OUT OF ANY BREACH OF THIS WARRANTY OR OTHERWISE.

**SKUTCH** ELECTRONICS, INC.

209 Kenroy Lane # 9

Roseville, California 95678

Voice (916) 786-6186

FAX (916) 783-1909

E-MAIL [skutch@inreach.com](mailto:skutch@inreach.com)

<http://www.skutchelectronics.com>



**SKUTCH** 

---

  
"Telecommunication Products to solve Telecommunication Problems"

# BA-704-2

**STAR Tone Activated  
Promotion-On-Hold Adapter  
(Two Line)**

**Version 1.05**

(S/N A4080001 and above)



Telephone**OnHold**.com  
1-866-359-4653

Music On Hold, Message On Hold & Commercials On Hold by  
TelephoneOnHold.com

## Introduction

Thank you for purchasing the Skutch BA704-2 Promotion-On-Hold Module. This unit allows all phones connected to your phone lines to provide music on hold to your customers. The BA704-2 can be installed on any telephone you wish. Once installed, all phones can access the BA704-2 unit. To place a call on hold, simply press the \* button on your telephone, then hang up or select another phone line. The call placed on hold can be answered at any phone. Pick up the line and the BA704-2 will automatically reset. The BA-704-2 is simple to use and is compatible with most makes and models of telephones. The BA1 is no longer supported by this unit.

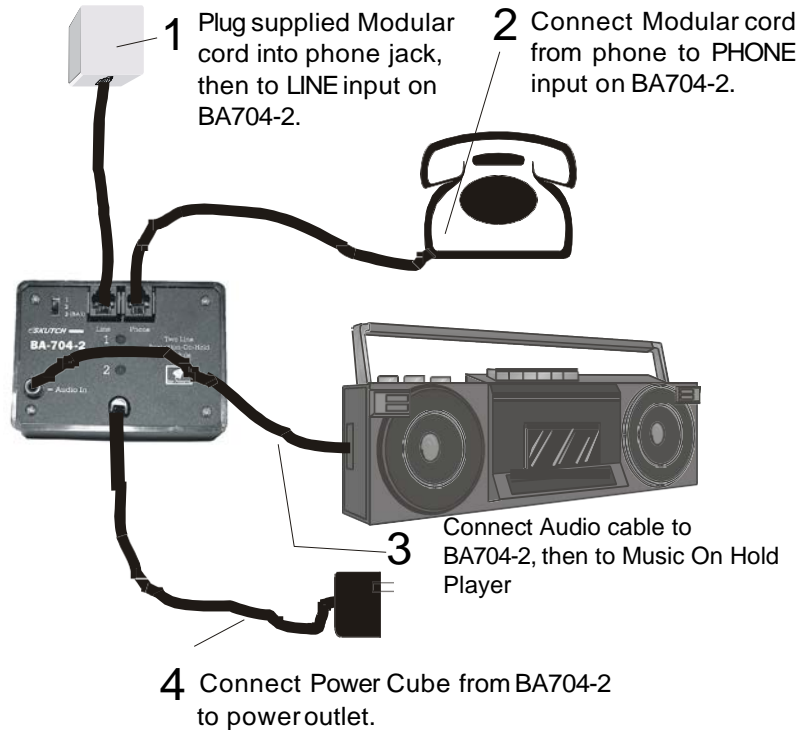

## Installation

### Operation

**To place a call on-hold**-Simply press the \* button on your telephone, then hang up or select another line.

**To release the hold condition**- Simply pick up any phone that is connected to that line, and the BA704-2 will automatically reset.

### Using STAR for other functions (voice mail).

If you need the \* button for other telephone functions, simply hold down the \* key for 3 full seconds and the BA704-2 will not activate.

## Lights on the BA704-2

**STEADY ON**- Indicates that the music on hold source is connected to the telephone line.

**POWER UP**- On initial power up, both lights will flash for approximately three seconds.

## 1-2-3 Switch

If your IN-USE lights on your phone do not light up when you place a call ON HOLD with the BA704-2, then try changing this switch. The normal position is position 3. The BA-1 is no longer supported by this unit.

## Tech Support (916) 786-6186

If you are unable to get your BA704-2 operational, feel free to call for technical support. Technical support is available from 7:30 AM to 4:30 PM Pacific Time, Monday – Friday.

## Program options:

The following is a list of the program options that the BA704-2 has to offer. To program the unit, simply pick up the phone, on either line, and dial the code. Audio will pulse in and out three times to confirm the program change.

####1 = Star to Activate \*

####2 = Pound to Activate

####3 = TT Detect Medium -85ms \*

####4 = TT Detect Long -150ms

####5 = NORMAL Mode \*

####6 = Star HOLD Mode

####7 = TT Detect Short -61ms

####8 = MUTE ON

####9 = Msg Waiting Feature ON

####0 = MUTE OFF/Msg Waiting Feature OFF \*

\*=Factory Settings (out of the box)

TelephoneOnHold.com  
1-866-359-4653

Music On Hold, Message On Hold & Commercials On Hold by  
TelephoneOnHold.com